

ASM-16/22 TOUCH II BARRIER WASHER EXTRACTORS



TOUCH II

User friendly and programmable Touch II Control with a 7" touch screen
 Display on dirty side
 USB Connection. PC software free of charge for programming, traceability, data analysis...
 37 available languages
 8 dosing signals as standard



OUTSTANDING FEATURES

Automatic positioning of drum
 2 water inlets
 Wet cleaning features ready
 G-FACTOR 350
 Traceability as standard
 Heating: electric, steam, and new dual heating model (electric+steam)



EFFICIENCY

Intelligent consumption
 Optimal loading
 Water Recovery tanks ready: ECOTANK
 Low water consumption
 High G-FACTOR: reduced residual moisture > reduced drying time



CONNECTIVITY

IoT - Domus Connect



ERGONOMICS

Huge door opening making loading/unloading easier
 Easy friendly drum opening by push button
 Loading height: door base 670 mm



MAINTENANCE

Electric components on the left side, mechanical components on the right side and connections on the top (protected from water and detergents)
 Central drain as standard
 Technical menu: statistics, alarms, autotest, data recovery for technicians and maintenance



OTHERS

2 opposed doors. Pass-through barrier washer.
 Ready to be connected to dosing pumps
 Grey skinplate outer casing
 Drum and vat in stainless steel AISI 304
 Frequency inverter to control imbalance
 CE approved product



OPTIONS

- 7" second screen on clean side
- Auto Weight: automatic weighing sensor system on feet (Includes kit with 6 extra dosing signals)
- Relay card with 6 extra dosing signals: up to 14 signals
- Printer
- IoT - DomusConnect communication
- Third water inlet
- Double drain
- Titration valve
- Side drain valve
- Low steam pressure (0,5 bar)
- Detergent box with 4 compartments
- Electric drum motor brake
- UPS Option (in case of power failure)
- End of cycle light alarm
- Plinth to align loading height (door base at 850mm)
- Stainless steel AISI 304 outer casing
- Stainless steel AISI 304 frame
- Stainless steel frame equipped with loading base
- Maritime wooden packing
- Plinth to align loading height (door base at 850 mm)
- Maritime voltage 440V III 50/60 Hz No Neutral (only for electric models)

TECHNICAL DATA	UNIT.	ASM-16 TOUCH II	ASM-22 TOUCH II		
DRUM					
Capacity 1:9 / 1:10	Kg	18 / 16	25 / 22		
Volume	l	158	220		
Diameter	mm	633	633		
Depth	mm	500	700		
Number of compartments	Nº.	1	1		
GENERAL DETAILS					
Washing speed / Spining speed	r.p.m.	45 / 1.000	45 / 1.000		
G Factor	-	350	350		
Maximum force transmitted	KN	5,5 ±1,12	6,25 ±1,54		
Frequency-dynamic force	Hz	16,7	16,7		
Sound level	dB	< 70	< 70		
Double drain	-	Opc	Opc		
Weighing System	-	Opc	Opc		
DOOR					
Height base door	mm	670	670		
Drum opening dimensions	mm	400 x 315	400 x 315		
Vat opening dimensions	mm	455 x 415	455 x 415		
POWER					
Motor	kW	2,2	2,2		
Electric heating power	kW	12	18		
Total electric power (electric model)	kW	14,2	20,2		
Total electric power (steam model)	kW	2,2	2,2		
CONNECTIONS		ELECTRIC / DUAL	STEAM	ELECTRIC / DUAL	STEAM
Tension 230V- I + N + T	Nº x mm2 / A	-	3 x 1,5 / 6A	-	3 x 1,5 / 6A
Tension 230V- III + T	Nº x mm2 / A	4 x 10 / 40A	-	4 x 10 / 50A	-
Tension 400V- III + N + T	Nº x mm2 / A	5 x 6 / 25A	-	5 x 6 / 32A	-
Steam inlet (Steam model)	inch	3/4"		3/4"	
Maximum steam consumption (Steam model)	Kg/h	9		12	
Water inlet	inch	3/4"		3/4"	
Water main pressure	Kgs/cm ²	3-5		3-5	
Maximum water consumption*	Lit/h	144		198	
Drain	mm/inch	3"		3"	
Drain Flow	Lit/min	160		160	
DIMENSIONS / PACKING DIMENSIONS					
Width / Width	mm	984 / 1.072		1.184 / 1.262	
Depth / Depth	mm	914 / 1.102		914 / 1.102	
Height / Height	mm	1398 / 1.530		1.398 / 1.530	
Net weight / Gross weight	kg	438 / 459		471 / 494	
Volume	m ³	1,81		2,13	

* N°2 Program, 100% load

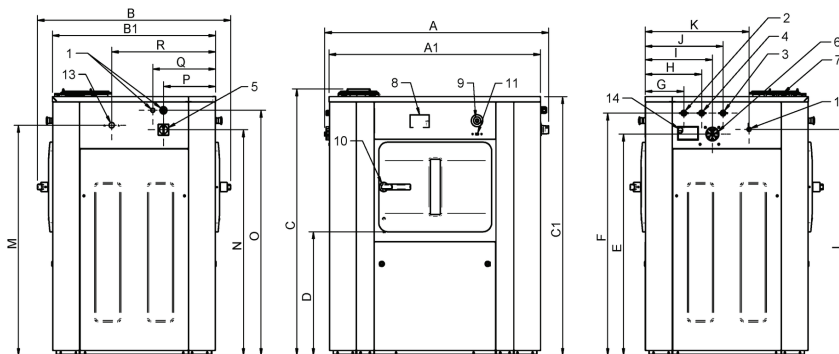

01. ELECTRICAL CONNEXION
02. HOT WATER
03. COLD WATER
04. SOFT WATER
05. MAIN SWITCH
06. LIQUID PRODUCTS INLET
07. DETERGENT BOX (OPTION)
08. CONTROL PANEL
09. EMERGENCY STOP
10. DOOR OPENING
11. USB PORT
12. DOSING PUMPS CONNEXION
13. STEAM INLET
14. EXHAUST

	A	B	C	A1	B1	C1	D	E	F	G	H	I	J	K	L	M	N	O	P	Q	R
ASM-16	1.054	1.082	1.426	984	914	1.385	661	1.184	1.296	217	317	377	437	582	1.209	1.231	1.207	1.311	292	352	582
ASM-22	1.254	1.082	1.426	1.184	914	1.385	661	1.184	1.296	217	317	377	437	582	1.209	1.231	1.207	1.311	292	352	582