



## TOUCH II

User friendly and totally programmable 7" Touch II  
USB Connection. PC software free of charge for programming, traceability, data analysis...  
Videos on display (ads, instructions)  
37 languages  
8 dosing signals as standard



## G FACTOR

High G-Factor:  
G-FACTOR 350



## EFFICIENCY

Intelligent consumption  
Optimal loading  
Water Recovery tanks ready: ECOTANK  
Low water consumption



## VERSATILITY

Electric < > Hot water  
Wet cleaning features



## CONNECTIVITY

IoT - Domus Connect standard.  
Remote technical service  
Management of laundries: OPL  
Remote payment



## ERGONOMICS

Biggest door diameters: Ø700  
Easy opening/closing system for door lock



## MAINTENANCE

Equivalent parts for all models: contactors, electronic devices, gear  
Technical menu: traceability, error diagnosis



## OTHERS

Drum and tub in stainless steel AISI 304  
3 water inlets  
Soft mounted, free standing washers.  
Panels in skinplate  
Easy to install, no need of fixation to the floor.  
CB and WRAS approved product. Option ETL  
High spin washers with suspended drum.



## OPTIONS

- DQ-2 Dosing pump kit
- Extra dosing pump DB-1
- Double drain
- Tropicalized model: protected board
- Tilting options: frontal or double tilt
- Auto Weight: automatic weighing sensor system on feet (Not available with tilting kits)
- Relay card with 6 extra dosing signals: up to 14 signals
- Stainless steel AISI 304 outer casing
- Double heating E+S
- Maritime voltage for electric models: 440V III 50/60 Hz  
No neutral

TECHNICAL DATA	UNIT.	DHS - 100C TOUCH II	DHS - 120C TOUCH II		
<b>DRUM</b>					
Load capacity 1:9 / 1:10	Kg	105/95	130/115		
Volume	l	950	1150		
Diameter	mm	1360	1360		
Depth	mm	637	775		
<b>GENERAL DETAILS</b>					
Washing speed / Spining speed	r.p.m.	34/678	34/678		
G Factor	-	350	350		
Maximum force transmitted	KN	37,77 ±5,25	37,77 ±5,25		
Frequency-dynamic force	Hz	11,33	11,33		
Noise level	dB	< 70	< 70		
Coin laundry version	-	No	No		
Double drain	-	Opt	Opt		
Weighing System / Tilting System	-	Opt / Opt	Opt / Opt		
SLUICE option	-	No	No		
<b>DOOR</b>					
Height center door / Height door	mm	1.330 / 900	1.330 / 900		
Diameter	mm	700	700		
<b>POWER</b>					
Motor	kW	15	15		
Electric heating power	kW	-	-		
Total electric power (electric model)	kW	-	-		
Total electric power (hw, steam model)	kW	15	15		
<b>CONNECTIONS</b>		<b>ELECTRIC</b>	<b>STEAM - HOT WATER</b>	<b>ELECTRIC</b>	<b>STEAM - HOT WATER</b>
Tension 230V - I + N + T	Nº x mm2 / A	-	-	-	-
Tension 230V - III + T	Nº x mm2 / A	-	3x25+T - 63A	-	3x25+T - 63A
Tension 400V - III + N + T	Nº x mm2 / A	-	4x10+T - 40A	-	4x10+T - 40A
Steam inlet (Steam model) inch	inch	1-1/4"		1-1/4"	
Maximum steam consumption (Steam model)	Kg/h	26,5		26,5	
Water inlet inch	inch	1-1/2"		1-1/2"	
Water main pressure	Kgs/cm2	2-4		2-4	
Maximum water consumption*	Lit/h	1058*		1254*	
Drain inch	inch	4"		4"	
Drainage capacity	Lit/min	500		500	
<b>DIMENSIONS / PACKING DIMENSIONS</b>					
Net Width / Gross Width	mm	1.836 / 1.900		1.836 / 1.900	
Net Depth / Gross Depth	mm	1.649 / 2.030		1.863 / 2.030	
Net Height / Gross Height	mm	2.245 / 2.290		2.245 / 2.290	
Net weight / Gross weight	kg	3.950 / 4.100		3.950 / 4.100	
Volume	m3	8,83		8,83	

\* Program n°2, 100% load

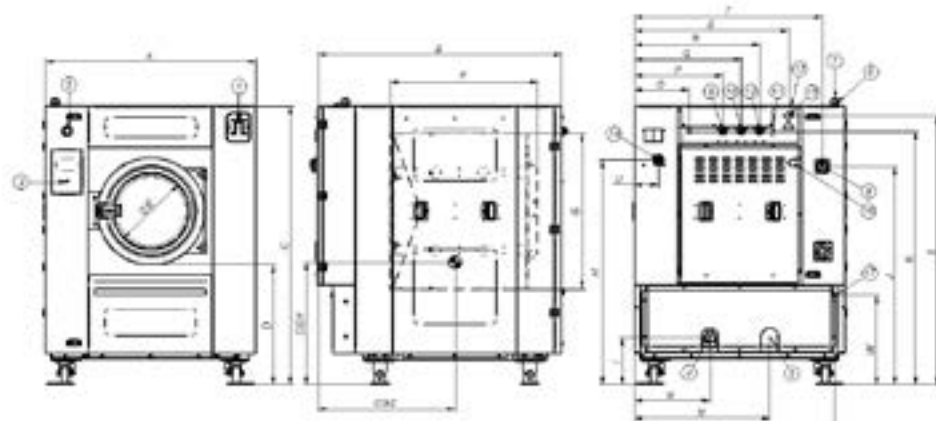

1. SOAP DISPENSER
2. EMERGENCY STOP
3. USB PORT
4. DRAIN 2
5. DRAIN 1
6. ELECTRIC CONNECTION TO LIQUID SOAP PUMPS
7. ELECTRICAL CONNECTION
8. MAIN SWITCH
9. AUXILIAR WATER INLET
10. HOT WATER INLET
11. EQUIPOTENTIAL CONNECTION
12. COLD WATER INLET
13. STEAM OUTPUT
14. LIQUID SOAP CONNECTION
15. STEAM CONNECTION
16. AIR INTAKE
17. ETHERNET PORT

	A	B	C	D	E	F	G	H	I	J	K	L	M	N	O	P	Q	R	S	T	U	V	W	CGY	CGZ	
DHS-100C	mm	1.765	1.650	2.245	945	700	792	1.350	1.740	336	1.781	2.038	2.110	675	1.092	494	634	774	954	994	1.239	1.646	165	2.049	853	1.025
DHS-120C	mm	1.765	1.832	2.245	945	700	930	1.350	1.740	336	1.781	2.038	2.110	675	1.092	494	634	774	954	994	1.239	1.646	165	2.049	853	1.130